



Equipped with AEM® Dryflow™ Filter
No Oil Required!

INSTALLATION INSTRUCTIONS

PART NUMBER

21-749C (Gun Metal Gray Finish)

2014	Hyundai	Santa Fe Sport	2.0L Turbo
2015	Hyundai	Santa Fe Sport	2.0L Turbo

Not legal for sale or use on any pollution controlled motor vehicle in California or states adopting California emission procedures. See AEMIntakes.com for CARB status on each part for a specific vehicle.

PARTS LIST

ITEM NO.	PART NUMBER	DESCRIPTION	QTY.
1	AEM-9440	HOSE CLAMP, 2.31-3.25"	1
2	AEM-5-1036	COUPLER	1
3	AEM-9456	1/2" BNDHOSE CLAMP,3.15"-4.00"	2
4	AEM-2-1527C	INTAKE TUBE; 3"OD X 18", 21-749	1
5	AEM-9448	1/2" BNDHOSE CLAMP,2.56"-3.50"	1
6	AEM-5-1046	HOSE, ADAPTER 3.00/3.50X2.5	1
7	102487	EDGE TRIM;3/4" BULB, TOP LOC., 46"L	1
8	07730	BOLT; M6 X 1.00 X 16MM , BUTTONHEAD	2
9	AEM-1-3025	WASHER, M6 SPLIT LOCK ZINC	2
10	08275	WASHER; 1/4"ID X 5/8"OD - SAE	4
11	AEM-20-8546	HEAT SHIELD; HYUNDAI SONATA/ SANTA FE	1
12	AEM-444.460.04	NUT; M6 HEX SERRATED	2
13	AEM-1228599	MOUNT, RUBBER 5/8" X 6MM	2
14	AEM-1-2108	BOLT; HEX/FLANGE M8-1.25 X 12	1
15	08272	WASHER; 8MM, FLAT, SS	1
16	06532	STANDOFF	1
17	21512-1	ADAPTER; UNIVERSAL, 6" FILTER 3.5"	1
18	AEM-94104	1/2" BNDHOSE CLAMP,4.125-7.00"	1
19	AEM-21-210EDK	AIR FILTER; 6" X 5" X 4.75" T DRYFLOW	1

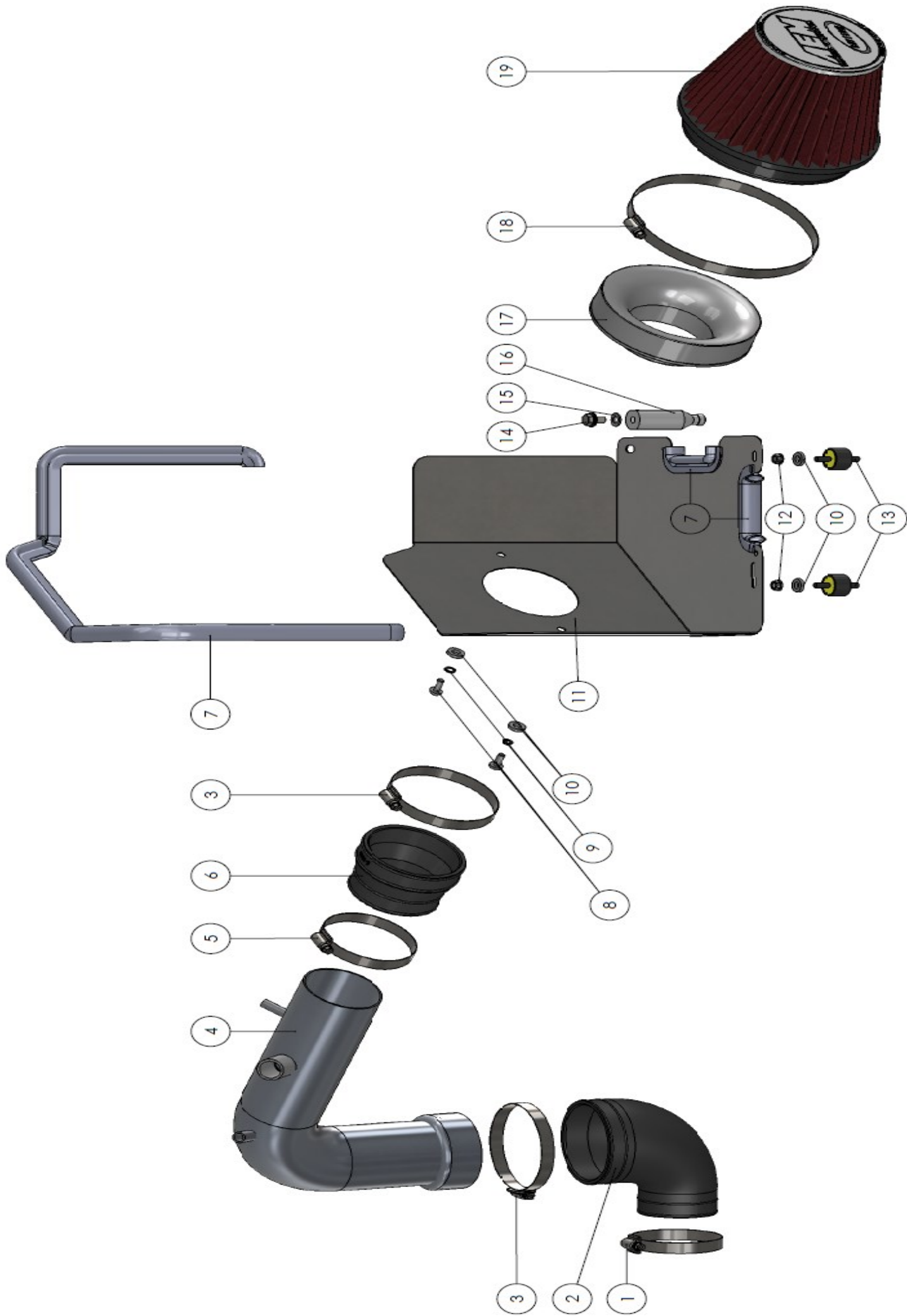

Read and understand these instructions **BEFORE** attempting to install this product. Failure to follow installation instructions and not using the provided hardware may damage the intake tube, throttle body and engine.

1. Preparing Vehicle

- a. Make sure vehicle is parked on level surface.
- b. Set the parking brake.
- c. If engine has run in the past two hours, let it cool down.
- d. Disconnect negative battery terminal.
- e. Do not discard stock components after removal of the factory system.
- f. Open the air intake kit package and make sure all parts are included.

Tools Needed:

Ratchet
3" & 6" Extension
8, 10, 12, 13mm Socket
Pliers
Knife/Razor Blade
Phillips Screwdriver

2. Removal of stock system

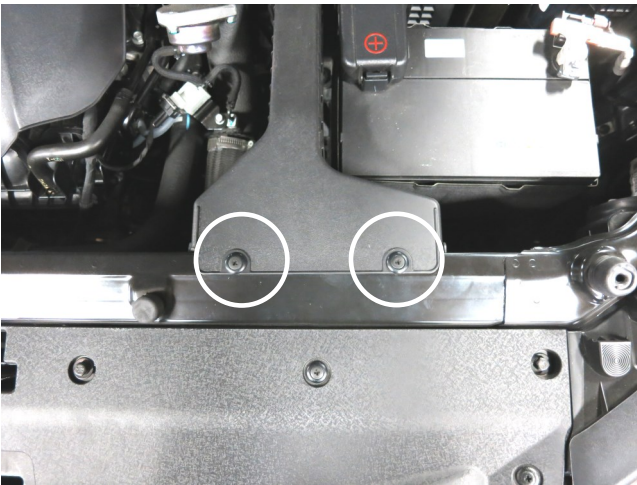

a. Remove the two plastic clips that secure the stock air scoop in place. These will be re-installed in step 3o.



b. Remove the battery hold down bolt circled and place it to the side. Then, remove the battery hold down. You will re-install these in step 3n.



c. Move the battery forward as shown.



d. Compress the 3 spring clamps circled and slide the hoses off the stock intake tube.



e. Loosen the bolt hose clamp securing the stock intake tube to the air box.

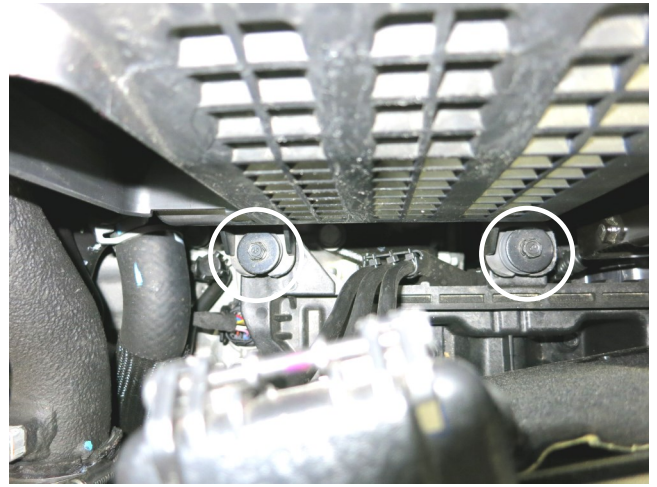

f. Remove the two bolts securing the air box to the vehicle. These will not be reused.



g. Remove the stock air box from the vehicle. Note: Do not discard any of your stock equipment.



h. Loosen the hose clamp securing the stock intake tube to the turbo compressor housing.

3. Installation of AEM® intake system.

a. When installing the intake system, do not completely tighten the hose clamps or mounting hardware until instructed to do so.

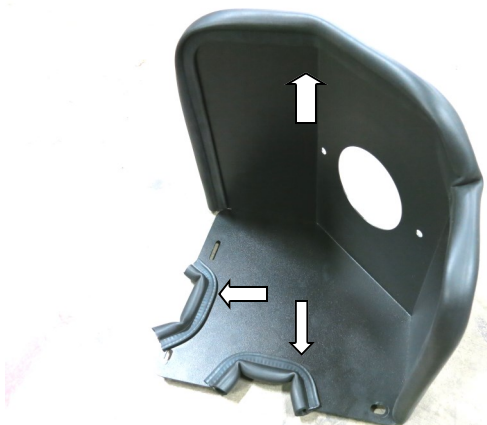

a. Install the edge trim around the heat shield as shown.
Note: Cut the edge trim to fit.



b. Install the filter adapter with supplied hardware.

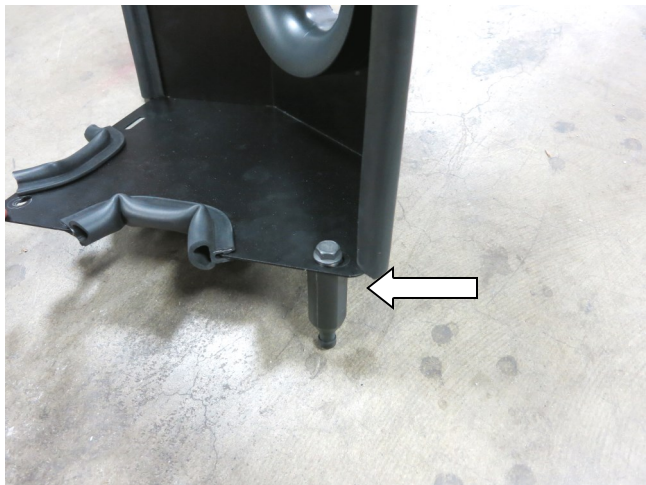

c. Install and tighten the stand off with the supplied hardware as shown.



d. Install the two rubber mounts into to vehicle.



e. Install the coupler with the supplied hose clamps onto the AEM intake tube. Note: Warm soap and water makes it easier to slide the tube into the coupler.



f. Install the AEM intake tube onto the turbo compressor housing. Do not tighten either hose clamp at this time.



g. Install the assembled heat shield into the vehicle aligning the two slots with the previously installed rubber mounts. Push down to secure the stand-off.



h. Install the washers and nuts, then tighten them to the rubber mounts.

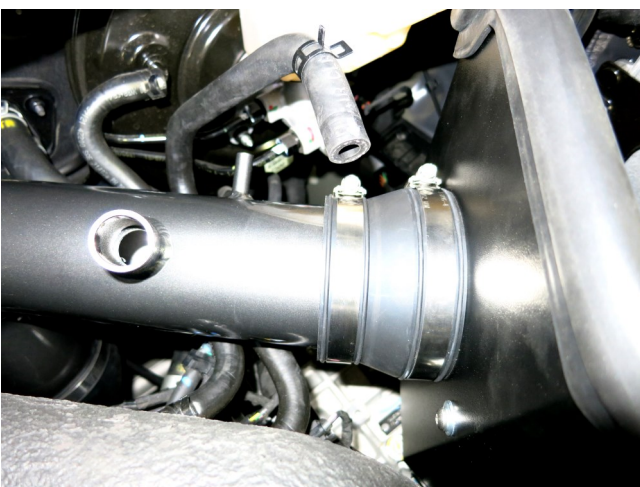

i. Install the hose with supplied hose clamps onto the heat shield and align the AEM intake tube with it.

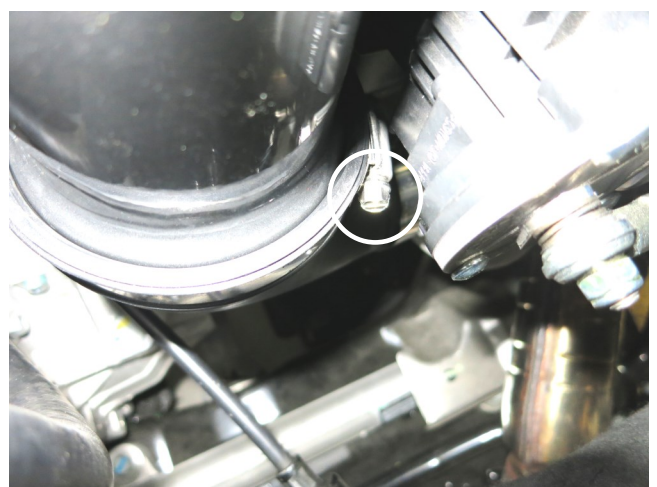

j. After AEM tube and heat shield are aligned, tighten the hose clamp circled on the lower coupler.

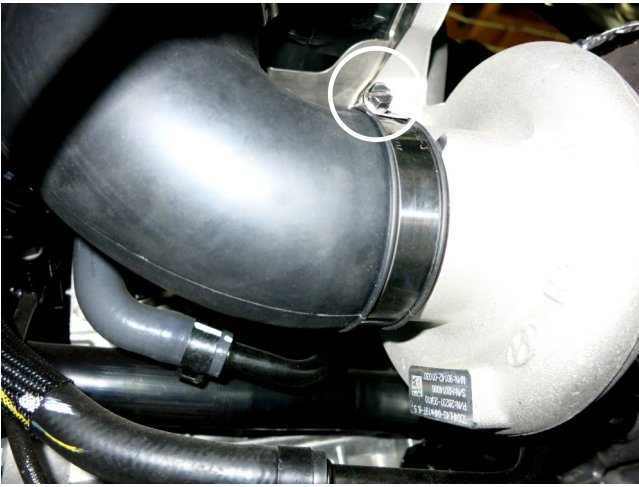

k. Tighten the hose clamp at the turbo compressor housing.



l. Tighten both coupler hose clamps shown.

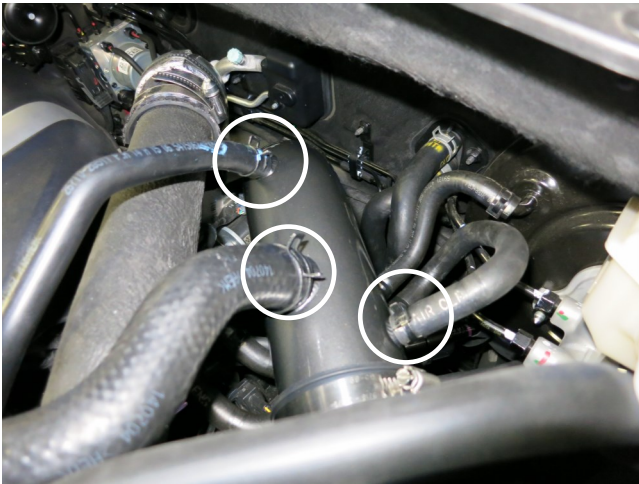

m. Re-install the three vent hoses with spring clamps that were removed in step 2d.



n. Position the battery back to its correct location, making sure it's all the way to the drivers side of the tray and re-install the battery hold down and bolt from step 2b.



o. Re-install the stock air scoop with the hardware that was removed in step 2a.



STOCK INTAKE INSTALLED



AEM INTAKE INSTALLED

4. Reassemble Vehicle

- a. Position the inlet pipes for the best fitment. Be sure that the pipes or any other components do not contact any part of the vehicle.
- b. Check for proper hood clearance. Re-adjust pipes if necessary and re-tighten them.
- c. Inspect the engine bay for any loose tools and check that all fasteners that were moved or removed are properly tightened.
- d. Reconnect negative battery terminal and start engine. Let the vehicle idle for 3 minutes. Perform a final inspection before driving the vehicle.

5. Service and Maintenance

- a. AEM Induction Systems requires cleaning the intake system's air filter element every 100,000 miles. When used in dusty or off-road environments, our filters will require cleaning more often. We recommend that you visually inspect your filter once every 25,000 miles to determine if the screen is still visible. When the screen is no longer visible some place on the filter element, it is time to clean it. To clean, purchase our Synthetic air filter cleaner, part number 1-1000 and follow the easy instructions.
- b. Use window cleaner to clean your powder coated AEM[®] intake tube.

NOTE: DO NOT USE aluminum polish on powder coated AEM[®] intake tubes.

For technical inquiries
e-mail us at
sales@aemintakes.com
or
call us at
800.992.3000

AEM Air Intake System Warranty Policy

AEM® warrants that its intake systems will last for the life of your vehicle. AEM® will not honor this warranty due to mechanical damage (i.e. improper installation or fitment), damage from misuse, accidents or flying debris. AEM® will not warrant its powder coating if the finish has been cleaned with a hydrocarbon-based solvent. The powder coating should only be cleaned with a mild soap and water solution. Proof of purchase of both the vehicle and AEM® intake system is required for redemption of a warranty claim.

This warranty is limited to the repair or replacement of the AEM® part. In no event shall this warranty exceed the original purchase price of the AEM® part nor shall AEM® be responsible for special, incidental or consequential damages or cost incurred due to the failure of this product. Warranty claims to AEM® must be transportation prepaid and accompanied with dated proof of purchase. This warranty applies only to the original purchaser of product and is nontransferable. Improper use or installation, use for racing, accident, abuse, unauthorized repairs or alterations voids this warranty. AEM® disclaims any liability for consequential damages due to breach of any written or implied warranty on all products manufactured by AEM®. Warranty returns will only be accepted by AEM® when accompanied by a valid Return Merchandise Authorization (RMA) number. Credit for defective products will be issued pending inspection. Product must be received by AEM® within 30 days of the date RMA is issued.

If you have a warranty issue, please call (800) 992-3000 and our customer service department will assist you. A proof of purchase is required for all AEM® warranty claims.

Not legal for sale or use on any pollution controlled motor vehicle in California or states adopting California emission procedures. See AEMIntakes.com for CARB status on each part for a specific vehicle.